

## **DaDo Illuminated Panic Strip Information Sheet**



## **DaDo** LED

### **Features**

- LEDs over full length
- Colour Options
- Operates over entire length
- Optional activation capabilities
- Tamper-proof
- Waterproof
- End-cap options
- Easy installation
- Robust and durable
- Reliable

The DaDo signalling system has been designed for a variety of signalling applications in domestic and commercial buildings as well as applications in transportation. It can be operated over its entire length so is ideal for situations where it is advantageous to have a long, continuous signalling switch. The switch incorporates LEDs, which can be used as a static display to make the strip easy to locate, or more dynamically, for example by flashing them when the strip is operated. The spacing of the LEDs depends on the length of the strip; LEDs are closer together on the shorter strips but more spaced apart on longer ones. This means that the illuminated strip always looks in proportion irrespective of length. It also has the technical benefit that the current demand is not excessive even on strips measuring several metres .

The system is simple, robust and reliable. The signalling section consists of three parts: the base aluminium mounting channel, a fully waterproof Tapeswitch® ribbon switch and the TPE top cover. Installation is very easy. After lead connections are made to the ribbon switch and the base is screwed to the wall, the switch is simply placed in the base, the LED strip clipped in place and then the top cover snapped into position. End caps make the transition from the DaDo system assembly to standard 25mm x 15mm cable trunking, allowing the wiring to be kept neat and tidy. Where internal wiring is used, closed end caps are available. Once the system is fully assembled it is tamper-proof and it is difficult to vandalize the switch.

### **Typical Applications:**

- **Police station custody suites**
- **Prison custody suites**
- **Detention centres**
- **Hospitals**
- **Care Homes**
- **Government offices**
- **Transportation**
- **Wet rooms**



### Activation Options

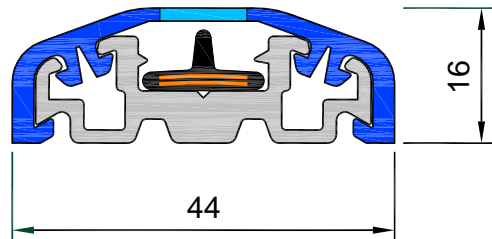

**HiSens**

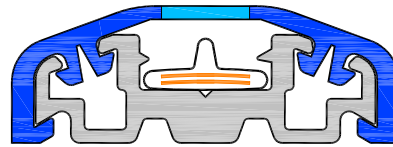

**LoSens**

The system is available in optional activation. The HiSens version is ideal for panic alarm situations where it is desirable that any contact with the strip, for example, even when someone is pushed into it, causes an alarm. If a great deal of accidental contact is envisaged, which would cause nuisance tripping of the alarm, the LoSens version may be more appropriate, since this is a more deliberate operation. The only difference between the two systems is that the HiSens uses a higher, black ribbon-switch and the LoSens uses a lower, white ribbon-switch.

### End-cap Options

Black or white end-cap kits are available, comprising: 2 x closed & 2 x trunking end-caps & 4 x grease-filled terminals

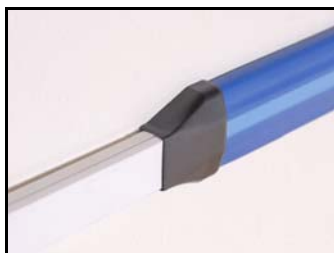

Trunking end-caps for transition to 25x15mm standard trunking

Closed end-cap for embedded cable installations

**Available Lengths**

**LED Spacing 150mm**

965mm	6 LEDs
1415mm	9 LEDs
1865mm	12LEDs
2315mm	15 LEDs
2765mm	18 LEDs
3215mm	21 LEDs
3665mm	24 LEDs
4115mm	27 LEDs
4565mm	30 LEDs
5015mm	33 LEDs

**LED Spacing 300mm**

3665mm	12 LEDS
4565mm	15 LEDs
5465mm	18 LEDs
6365mm	21 LEDs
7265mm	24 LEDs
8165mm	27 LEDs
9065mm	30 LEDs
9965mm	33 LEDs

**Note**

Supply voltage for LEDs is 12Vdc as standard. Current demand is (No. of LEDs x 5mA).

**Order Code**

**Complete DaDoLED System**

**DaDoLED/XXX/Hi/XX/XXXX/DL/XXX**

